

# D-BOX GEN II ACTUATORS

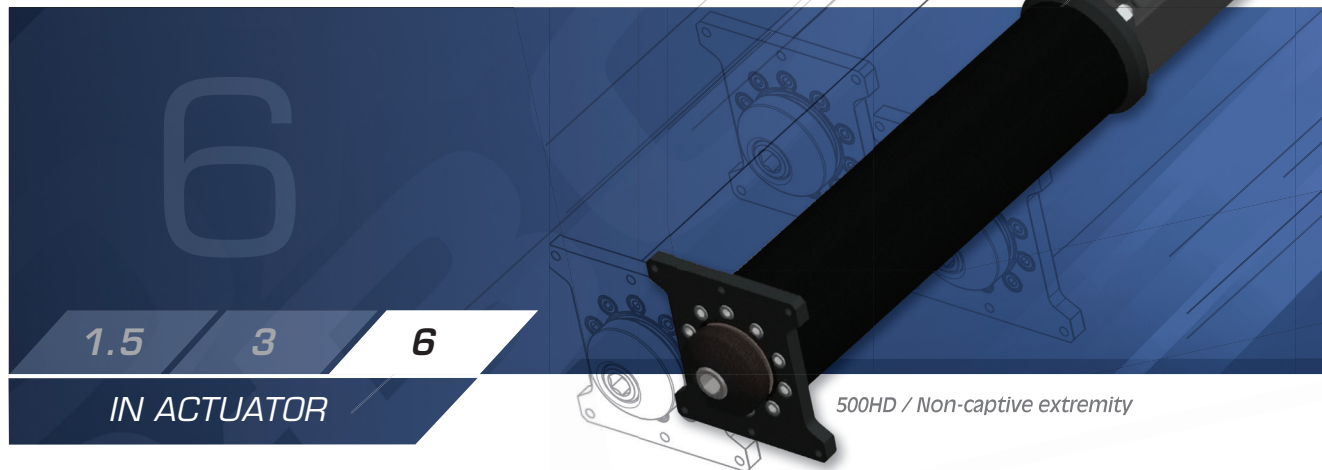

Configurations can encompass from 1 to 7 actuators in order to replicate the expected degrees of freedom (DOF). Vertically installed Gen II Actuators deliver three axes of movement (roll, pitch and heave). Horizontally installed Gen II Actuators deliver three axes of movement (sway, surge and yaw). Our basic "i" model can support most configurations. The HD model is intended for more robust and intensive usage. Users can choose between Captive and Non-Captive extremities as well as attachment brackets with L and U options.

## PERFORMANCES

FEATURES		500HDI
Actuator orientation		Vertical/Horizontal
Power requirement		120V / (230V with ACM 230S)
Maximum vertical lift		6" / 152,4 mm
Maximum velocity		± 100 mm/sec
Maximum acceleration		± 1 g-force
Frequency range		0-100 Hz
Operating T° range		0-40°C
Operating humidity		10 to 75%

FEATURES		500HDI
Max. lifting capacity / Actuator*		500 lb / 227 kg
Max. horizontal capacity / Actuator		In case of an horizontal installation of actuators, it is considered as average result that translation on limited friction surfaces can be done on weights up to 3 times nominal lifting capacity of Gen II Actuators.
POWER REQUIREMENT (120V KIT)	- 2 Actuator Kit	120 VAC, 60 Hz, 5 A120
	- 3 Actuator Kit	120 VAC, 60 Hz, 7,5
	- 4 Actuator Kit	120 VAC, 60 Hz, 10 A
POWER REQUIREMENT (230V KIT)	- 2 Actuator Kit	230 VAC, 60 Hz, 2,7
	- 3 Actuator Kit	230 VAC, 60 Hz, 4 A
	- 4 Actuator Kit	230 VAC, 60 Hz, 5,5 A

NOTE: It is not recommended to connect your D-BOX system to a GFCI breaker type

Electric consumption\*\*\* 2 actuators setup 17\$ / year ; 4 actuators setup 32\$ / year.

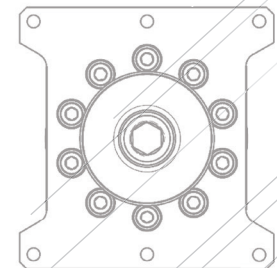

\* Weight distribution must be evenly spread on the activated motion platform to ensure Actuator maximum payload, inquire for more information.

\*\*\* Based on a scenario of 250 lb, 8 hours per day at a cost of 0.08 \$ kW/h.

## EXTREMITIES

Actuator extremities can be captive or non captive.

1. Allows the actuator to be attached to a sub-platform or on solid ground
2. For free flowing push against the floor with provided cupholder

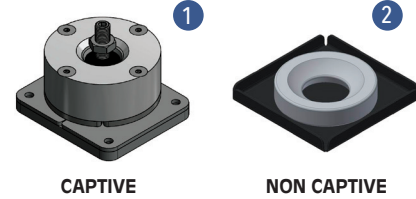

## OVERALL DIMENSIONS

The 500HDi model is shown below. For specific information regarding other models, please email: [simulation@d-box.com](mailto:simulation@d-box.com)

### NON-CAPTIVE

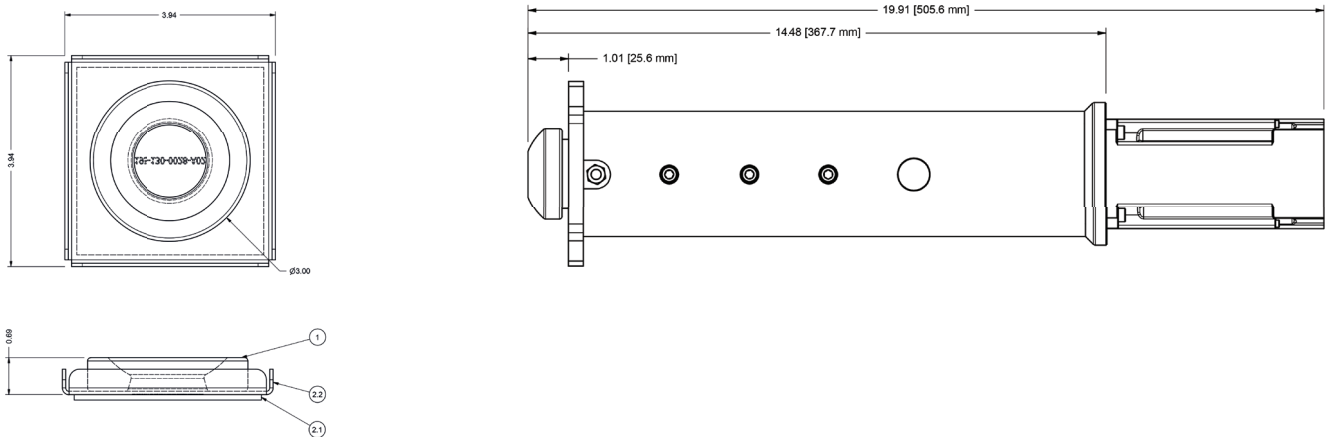

### CAPTIVE

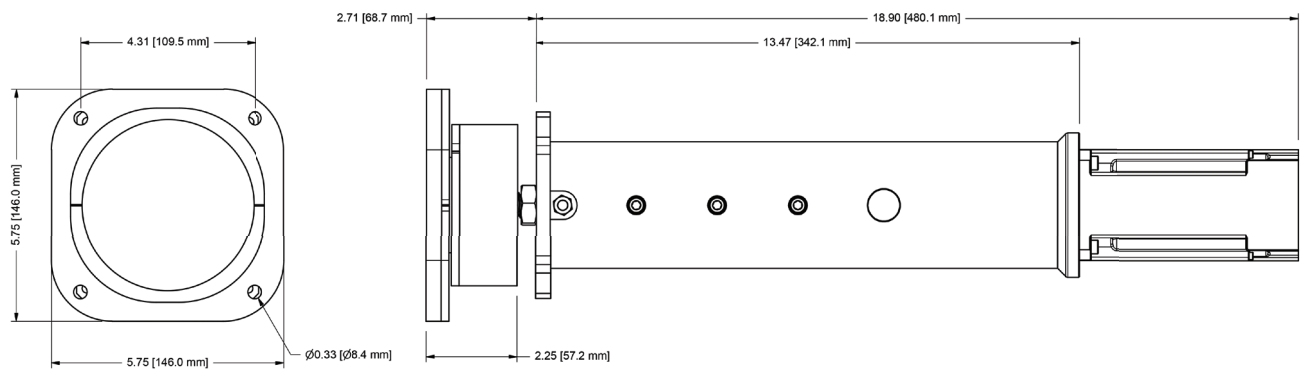

© 2016 D-BOX Technologies. All Rights Reserved. Specifications are subject to change without notice. D-BOX is a registered trademark.  
All other brand or product names are trademarks of their respective owners. Product photos and pictures are for illustration purposes only and may differ from the real product's appearance.

[dbox.com](http://dbox.com)



**D-BOX**  
Move the World®