

Pocket Geek Shop Fitout



ASSURANT®



Pocket Geek

Standard

- We are required to maintain the same standard for all franchise outlets.
- We have provided are the dimensions from the last shop for you to be able to provide us with a Budget Price, to enable us to select a supplier.
- Once the agreements are in place and the premises acquired, obviously the dimensions will change, at which time you will be requested to provide a detailed quote.
- The standard fittings are listed.
- Signage to be provided by Pocket Geek

Floor Plan - Showroom

- A** Check In & Repair Desk
- B** Device & Accessory Display
- C** Device Nesting Table
- D** Accessory Wall Display
- E** Accessory Gondola Display
- F** ISOD Display

Show room Dimensions

29' 7" wide

34' 4" long

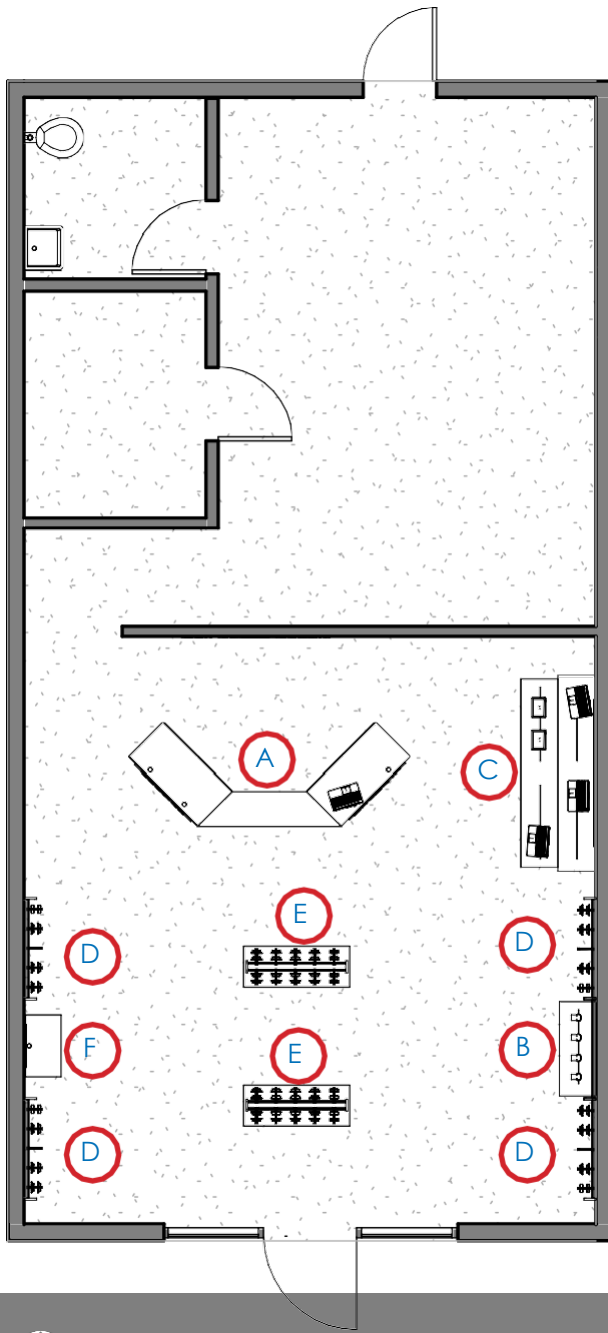

FLOOR PLAN - BACK OF HOUSE

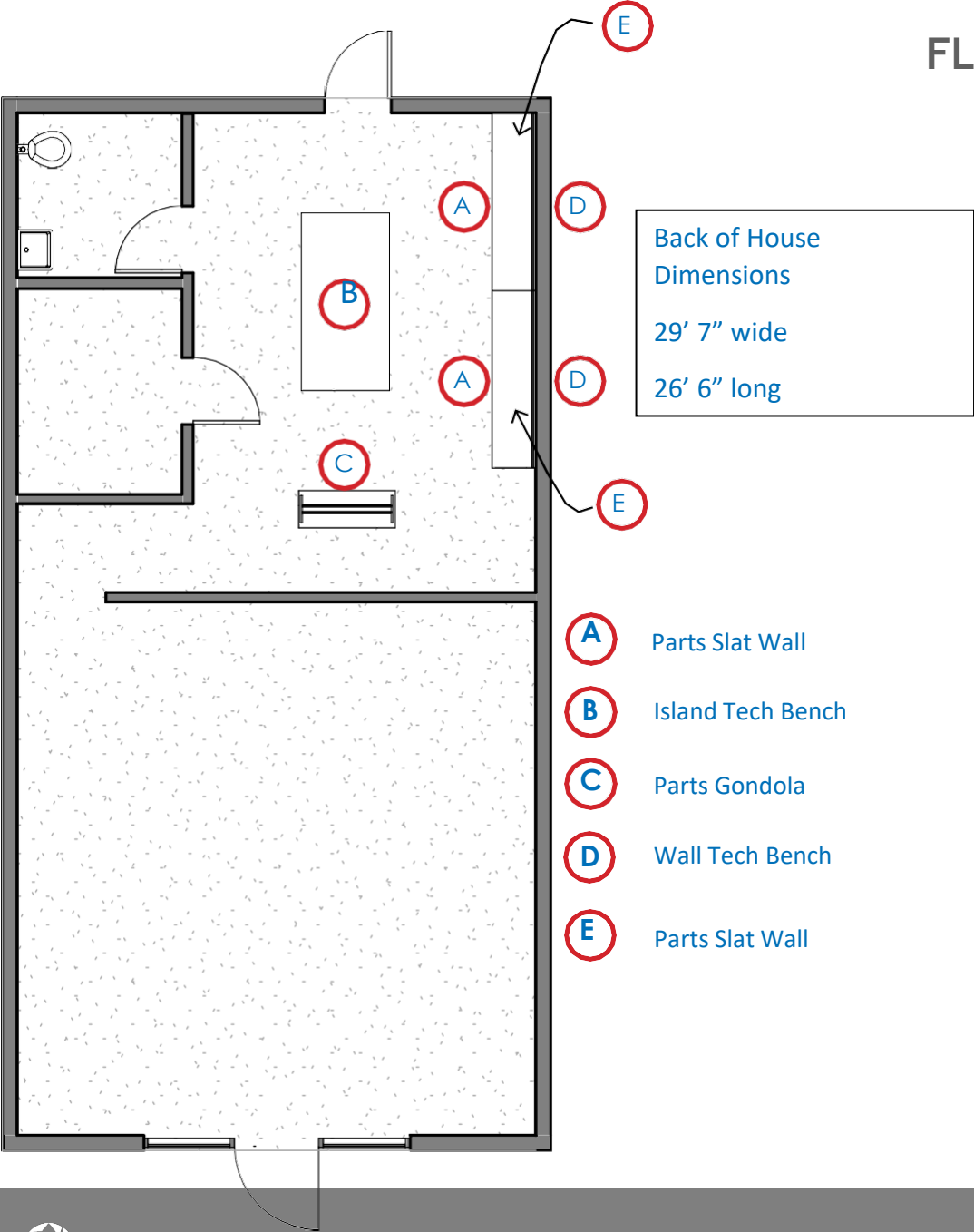

Point of Sale

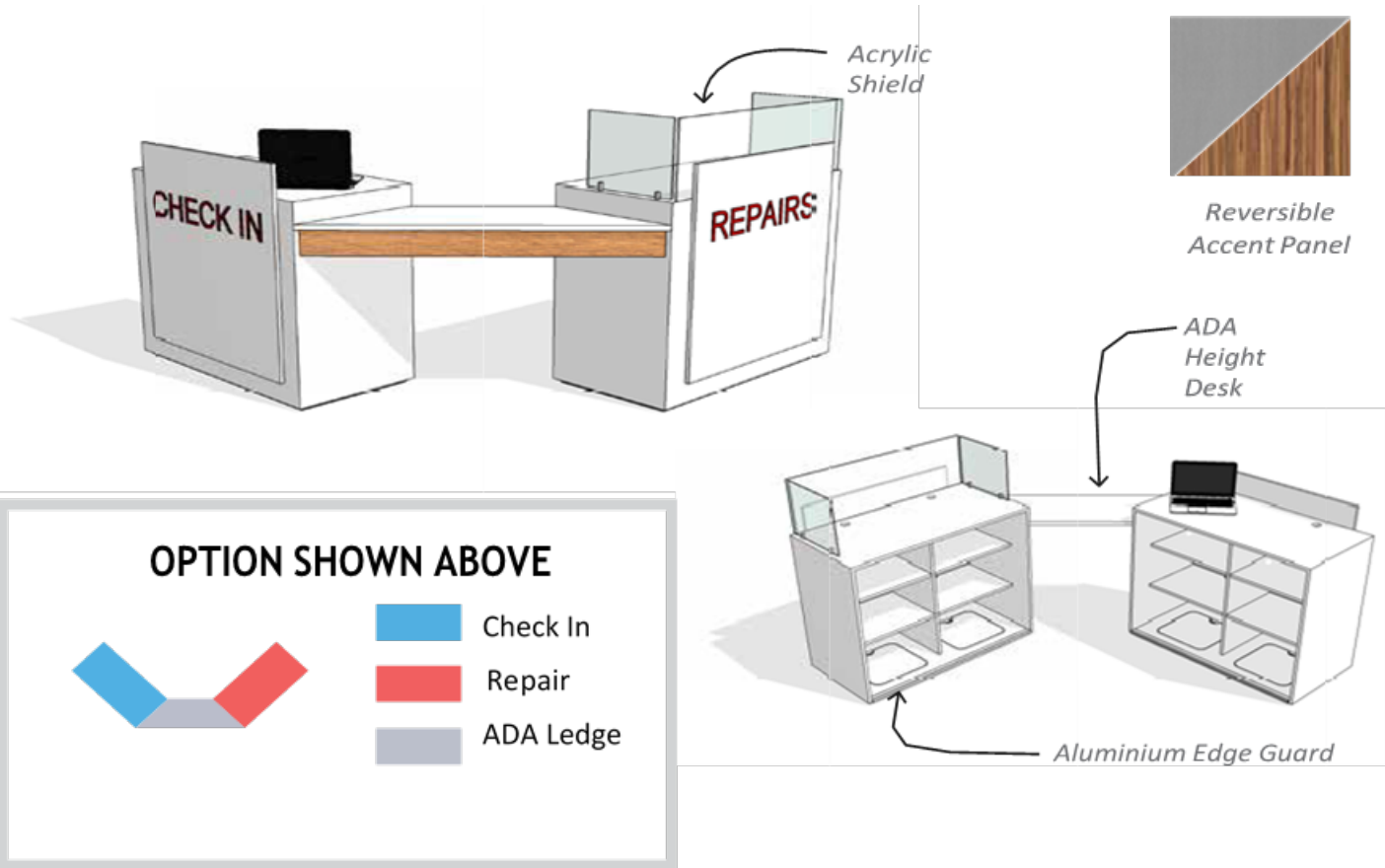

45 Degree Check-in/Repair - 126" W x 50" D x 52" H (38" COUNTER)

Show Room

WALL DISPLAY

1 Unit per Fixture

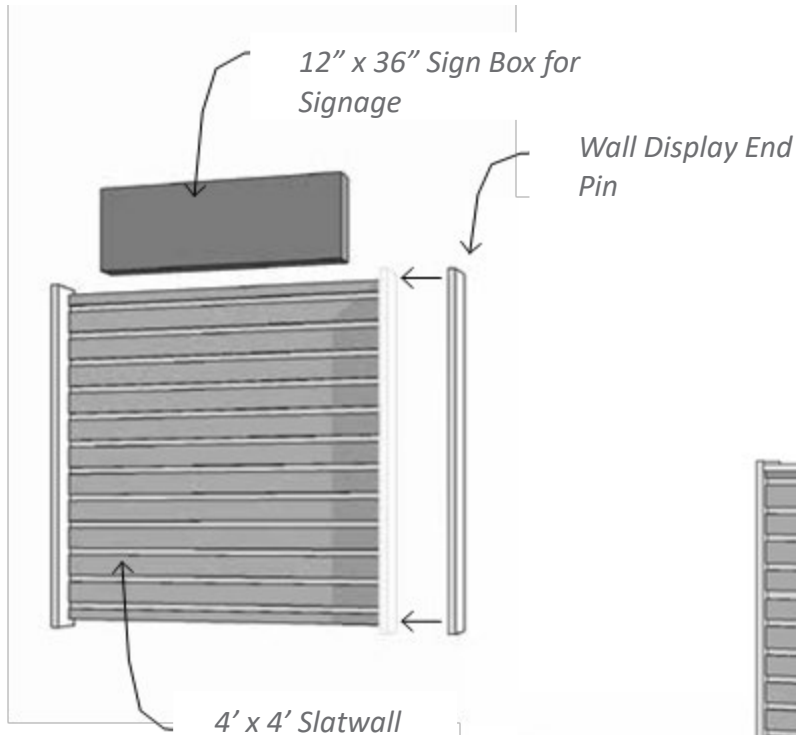

ACCESSORY GONDOLA

2 Units per Fixture

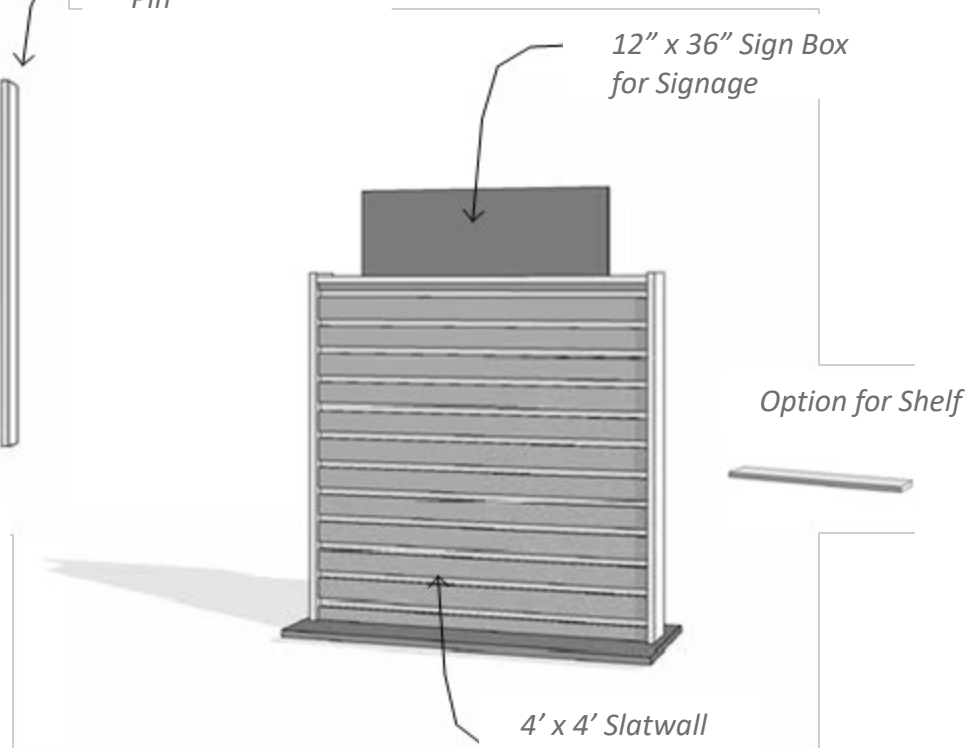

Example Configurations:

4 Wall Displays & 2 Accessory Gondolas
6 Wall Displays & 1 Accessory Gondola

Show Room

ISOD Wall Display 30" W x 18" D x 75" H

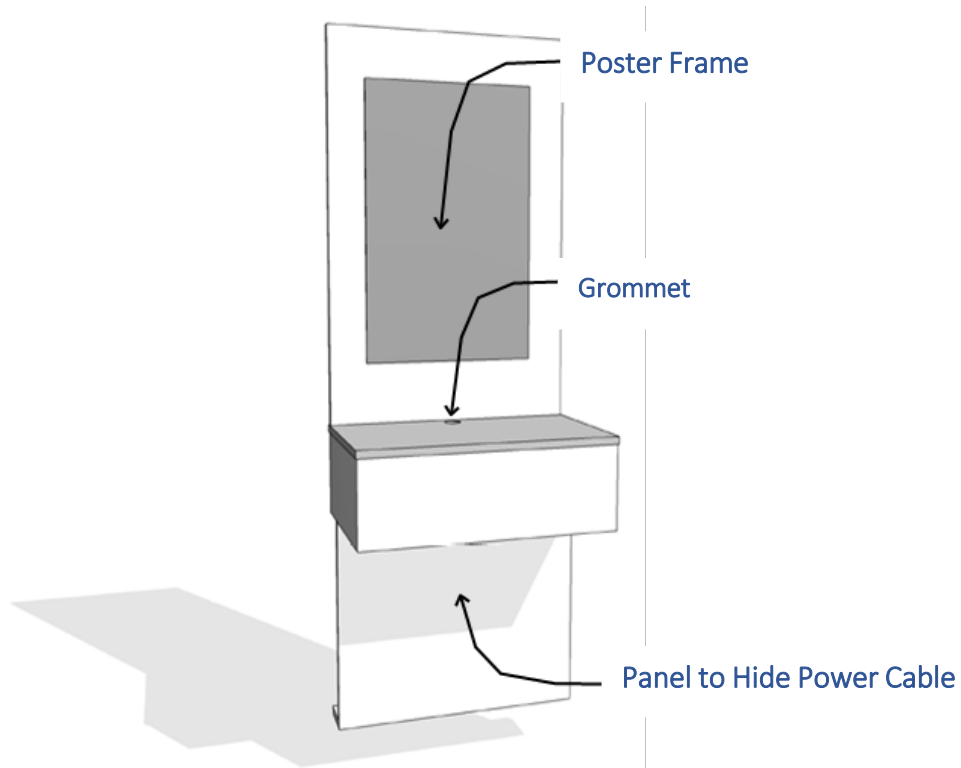

Accent Light 4.5" W x 6.5" H



Employee Stool



Customer Chair



Back Room

TECH BENCHES

WALL TECH BENCH 96" W x 24" D x 41" H

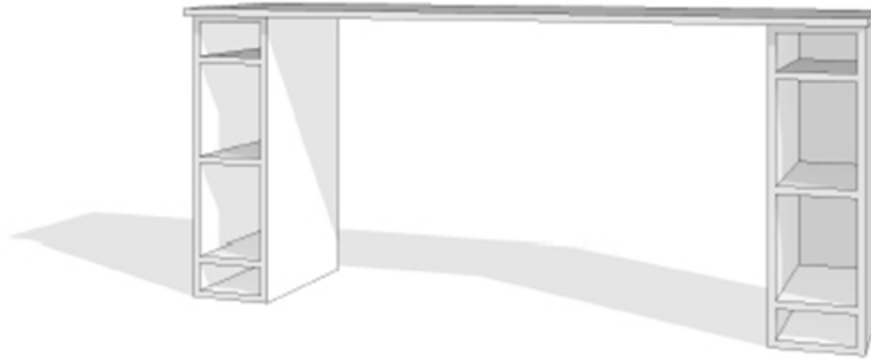

ISLAND TECH BENCH 96" W x 48" D x 41" H

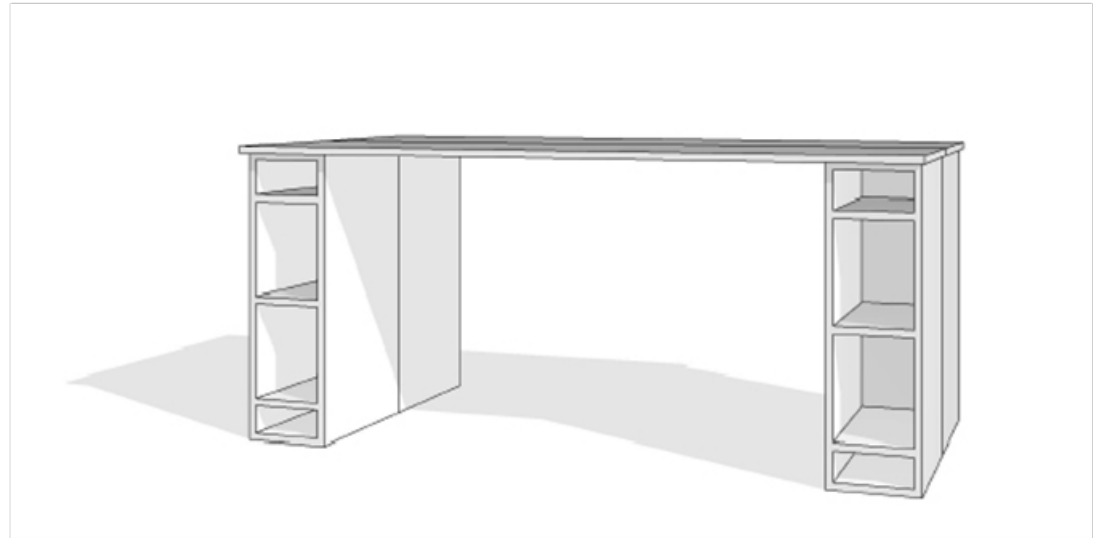

Paint

Images are for visual reference only and not to be used for colour matching.

PT-1

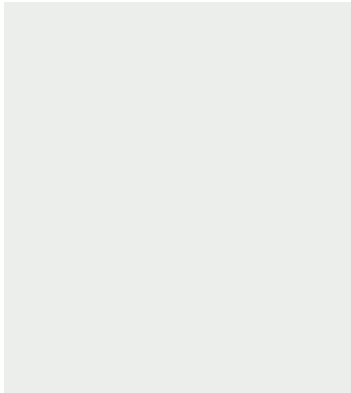

PT-2

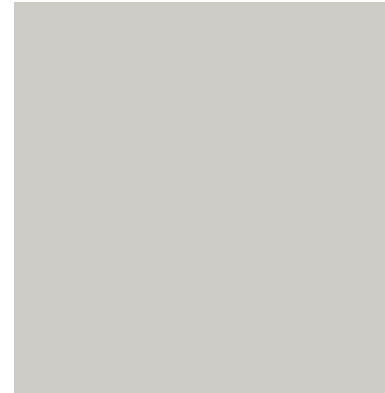

Flooring

Flooring style is intended to mimic polished or stained concrete ranging in shades from grey to grey-brown. The flooring should be neutral in colour, minimal in texture or pattern, and should not distract from the overall storebuild. Please see options below.

OPTIONS

1. Commercial Option - Please see next page
2. Polished or Stained Concrete
3. Flooring of your choice that meets the outlined criteria

****Any deviations from option #1 are required to be reviewed and approved by Pocket Geek Corporate. The use of unapproved flooring is NOT permitted. Franchisee owners are responsible for ensuring a professional installation, regardless of which flooring option is selected****

DO'S



DON'TS



Any Questions?