

T-Leg Tables | Fixed

T-Leg tables are available with a half-round top and fixed T-Legs. Standard height is 29"; 25" and 27" heights are available.

1-1/8" Particleboard Core with Flat Edge (F)

TOP is constructed of a 1-1/8" thickness 45# particleboard core with high-pressure laminate (HPL) top surface and phenolic backer sheet for balanced construction. 1-1/8" flat edge is secured to the bottom throughout the perimeter of the top to prevent the edge from pulling away. All tops have a 2.0" corner radius.

Fixed Leg Assembly

Fixed leg assembly features top mounting plates and leg assembly. Top mounting plates are 3/16" thick steel plate, painted black. Leg assembly includes a vertical upright that is oval shaped extruded aluminum, approx. 1-7/8" x 3-3/4" with internal ribbing and a die-cast aluminum foot with a designed crown and flair to shape with internal ribbing. Foot includes 7/16" friction ring install for casters and 5/16-18 thread for glides. Foot is secured to vertical upright using four (4) 1/4-20 x 1.5" bolts. Vertical upright is secured to the mounting plate using four (4) 1/4-20 x 1.5" bolts. Leg assemblies are secured to the top using eight (8) #12 x 3/4" wood screws. Foot and vertical uprights are powder coat paint. Leg assemblies are non-handed and can be installed on either side. Mounting plate orientation and placement defined by pilot hole-pattern in top.

Casters

Optional 75mm dual-wheel hard casters in black only. Caster is press-fit with 7/16" friction ring stem for installation.

Compliance

- > Tested to applicable ANSI/BIFMA Furniture Standards
- > Indoor Advantage™ Gold. Indoor air quality certified to SCS-EC10.3-2014

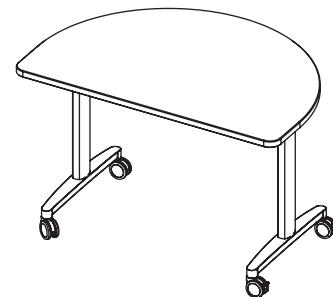

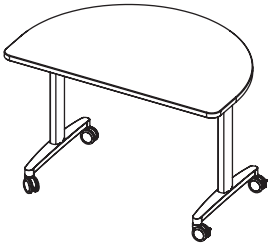

T-Leg Tables | Fixed Half Round

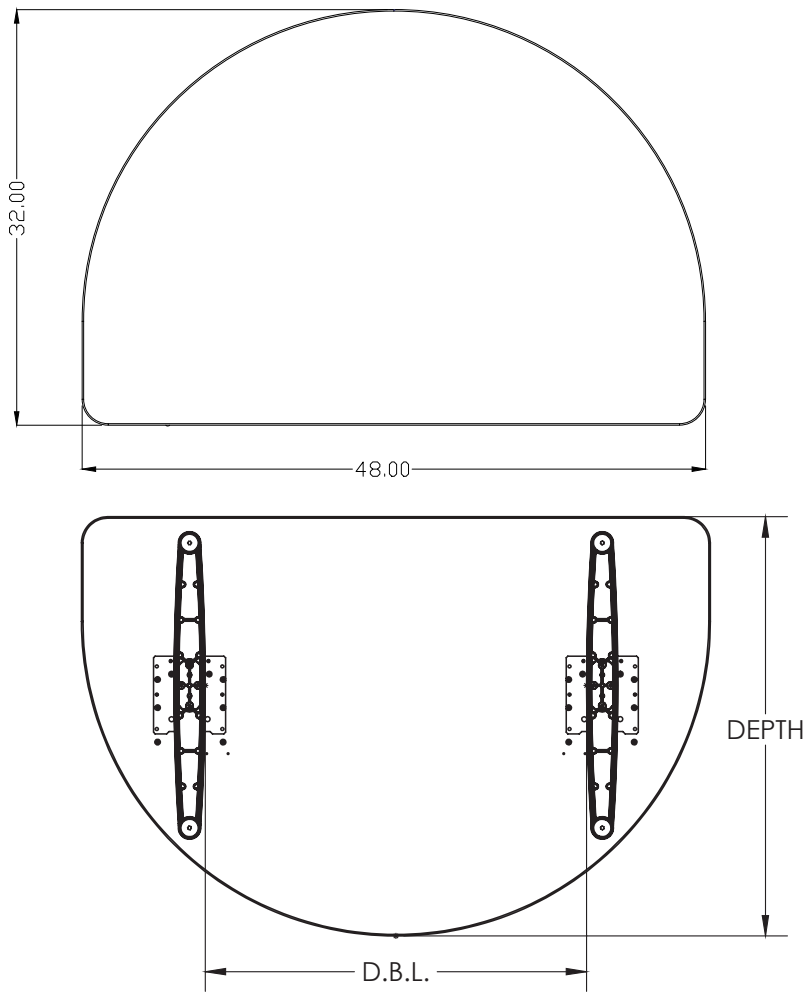

MODEL	DEPTH"	WIDTH"	HEIGHT"	D.B.L.
DTF-HR48F	32.0"	48.0"	29.0"	29.12"
DTF-HR60F	30.0"	60.0"	29.0"	29.0"
DTF7HR48F	32.0"	48.0"	27.0"	29.12"
DTF7HR60F	30.0"	60.0"	27.0"	29.0"
DTF5HR48F	32.0"	48.0"	25.0"	29.12"
DTF5HR60F	30.0"	60.0"	25.0"	29.0"

Notes

D.B.L. — distance between legs